

## Datasheet

### Rod eye SGS

Scope of delivery:  
1 rod eye, 1 hex nut to DIN 439

Material:  
Galvanised steel

RoHS-compliant  
LABS (PWIS) conformity:  
VDMA24364-B2-L

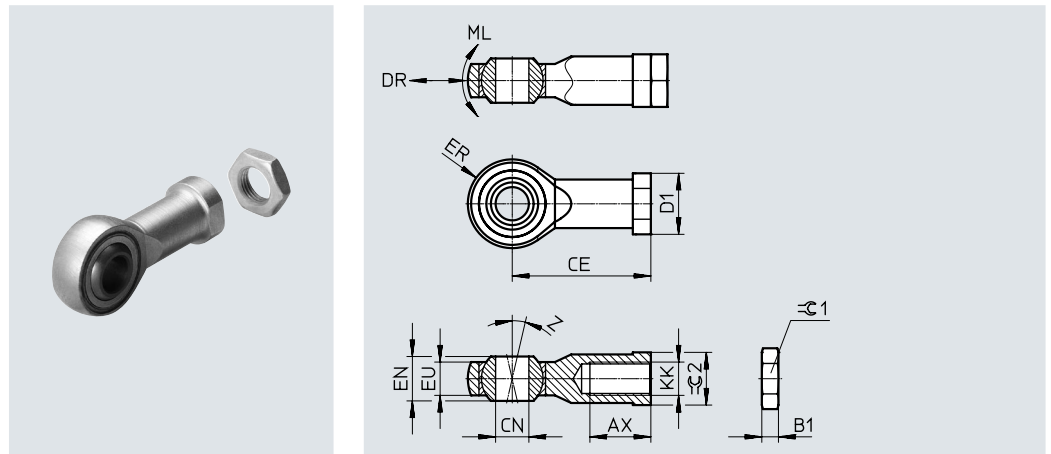

#### Dimensions and ordering data

KK	AX	B1	CE	CN Ø H7	D1 Ø	DR <sup>1)</sup> max. [µm]	ER ±0.5	EN	EU
<b>M4</b>	10 -2	2.2	27±1.2	5	12	34	9	8	6
<b>M6</b>	12 -2	3.2	30±1.2	6	14	34	10	9	6.8
<b>M8</b>	16 -2	4	36±1.2	8	17	40	12	12	9
<b>M10</b>	20 -2	5	43±1.2	10	20	40	14	14	10.5
<b>M10x1.25</b>									
<b>M12</b>	22 -2	6	50±1.2	12	23	45	16	16	12
<b>M12x1.25</b>									
<b>M16</b>	28 -2	8	64±1.2	16	29	45	21	21	15
<b>M16x1.5</b>									
<b>M20x1.5</b>	33 -2	10	77±1.7	20	37	55	25	25	18
<b>M27x2</b>	51 -2	13.5	110±1.7	30	52	55	35	37	25
<b>M36x2</b>	56 +2	18	125±2.1	35	60	60	40	43	28
<b>M42x2</b>	60 +2	21	142±2.1	40	69	60	45	49	33
<b>M48x2</b>	65 +2	24	160±2.1	50	78	60	58	60	45

1) Max. play DR up to max. friction torque ML possible.

<https://www.markazbargh.com/product-category/pneumatic-cylinder/>

## Datasheet

KK	ML <sup>2)</sup> max. [Nm]	Z [°]	⊖1	⊖2	ISO 12240-4 Dimensional series K	CRC <sup>3)</sup>	Weight [g]	Part no.	Type
<b>M4</b>	0.1	13	7	9	–	1	21	<b>9253</b>	<b>SGS-M4</b>
<b>M6</b>	0.13	13	10	11	■	1	29	★ <b>9254</b>	<b>SGS-M6</b>
<b>M8</b>	0.18	13	13	14	■	1	53	★ <b>9255</b>	<b>SGS-M8</b>
<b>M10</b>	0.23	13	17	17	■	1	88	<b>9256</b>	<b>SGS-M10</b>
<b>M10x1.25</b>					–	1	87	★ <b>9261</b>	<b>SGS-M10x1.25</b>
<b>M12</b>	0.28	13	19	19	■	1	131	<b>9257</b>	<b>SGS-M12</b>
<b>M12x1.25</b>					–	1	129	★ <b>9262</b>	<b>SGS-M12x1.25</b>
<b>M16</b>	0.4	15	24	22	■	1	263	<b>9258</b>	<b>SGS-M16</b>
<b>M16x1.5</b>					–	1	259	★ <b>9263</b>	<b>SGS-M16x1.5</b>
<b>M20x1.5</b>	0.55	15	30	30	■	1	464	★ <b>9264</b>	<b>SGS-M20x1.5</b>
<b>M27x2</b>	0.85	15	41	41	–	1	1333	<b>10774</b>	<b>SGS-M27x2</b>
<b>M36x2</b>	1	15	55	50	■	1	2084	<b>10775</b>	<b>SGS-M36x2</b>
<b>M42x2</b>	1.2	15	65	55	■	1	3132	<b>10776</b>	<b>SGS-M42x2</b>
<b>M48x2</b>	1.5	12	75	65	■	1	5498	<b>10777</b>	<b>SGS-M48x2</b>

2) Max. friction torque ML up to max. play DR possible.

3) In the area of the ball: CRC 0

More information [www.festo.com/x/topic/crc](http://www.festo.com/x/topic/crc)

<https://www.markazbargh.com/product-category/rod-pneumatic-cylinder/>